



BMW Parts and Accessories Installation Instructions

Alarm Kit Installation Instructions

for BMW Z4 (E85) US roadster Beginning Production April 2003

KIT P/N 65 73 0 302 424

BMW of North America, LLC

Product & Service Engineering Dept.

April 2003

GENERAL INFORMATION

INTRODUCTION

These installation instructions were produced to give the installation technician all necessary information to install the BMW Alarm Kit P/N 65 73 0 302 424 into factory pre-wired Z4 roadster vehicles produced beginning April 2003.

These instructions were developed by the Product and Service Engineering Department at BMW of North America, LLC specifically for BMW vehicles and are not to be compared to any existing products for vehicles other than BMW.

These instructions were complete and up to date at time of issue. Any changes in the vehicle or problems encountered by installation technician should be reported directly to the BMW Product and Service Engineering Department.

Read all instructions carefully before proceeding with this installation procedure. Instructions dealing with a stock part of the vehicle, but not given in detail should be referenced with the latest service, technical and diagnostic information provided on the DISPlus/GT1.

Left hand (LH) and right hand (RH) referenced in these instructions are determined from the driver's seat facing forward.

The installation time for this kit is 0.75 hour depending on condition of vehicle and equipment installed.

REQUIRED TOOLS

Common hand tools

KIT PARTS CONTENTS

1 ea.	07 12 9 904 323	ST4.8-2 cage clip
1 ea.	07 11 9 901 299	ST4.8 x 16 hex head screw with captive flat washer
1 ea.	61 31 8 374 745	Switch
1 ea.	61 31 6 915 326	Bracket for switch
1 ea.	65 75 6 923 169	Siren USA (with built-in tilt-sensor)
1 ea.	65 75 6 908 841	Bracket for siren
3 ea.	11 61 1 708 413	M6 hex nut w/washer

Contents

Section	Page
Introduction	1
Required Tools	1
Kit Parts Contents.....	1
Contents.....	2
1. Alarm Hood Switch Installation.....	3
2. Alarm Siren Installation	5
3. Coding of Alarm System	6

1. Alarm Hood Switch Installation

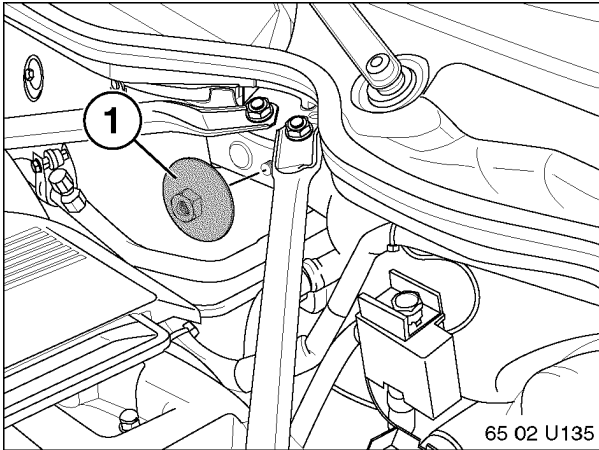

1.1
Locate and remove plastic fastener (1).

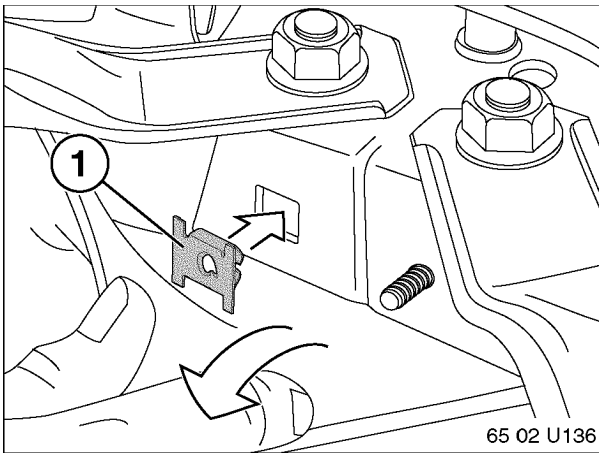

1.2
Push down cover to reveal rectangular shaped opening. Install cage clip by pushing clip into opening until clip seats into position.

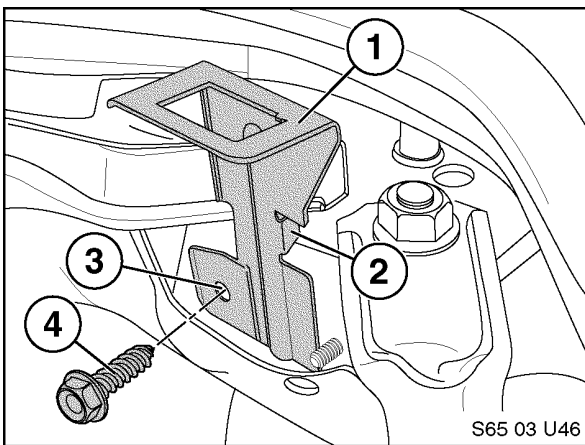

1.3
Position hood switch bracket (1) so that right angle tab (2) makes contact with horizontal surface while round hole (3) is aligned with center opening of cage clip. Secure bracket (1) in place with self-tapping 4.8x16 hex head screw with washer (4).

1. Alarm Hood Switch Installation

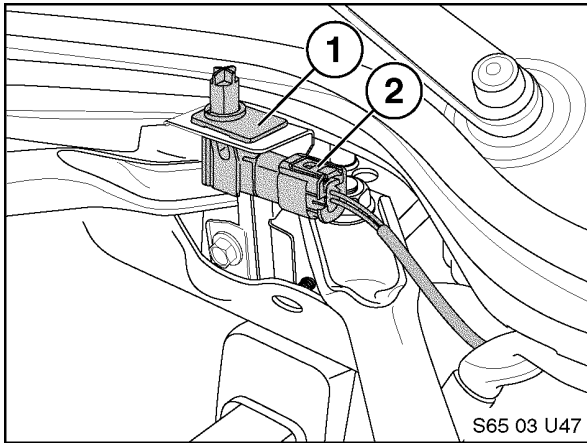

1.4
Install hood switch (1) into bracket.

1.5
Locate 3-position hood switch connector found behind brake master cylinder booster. Remove securing tape and neatly direct hood switch connector and harness to bracket area.

1.6
Remove protective cover from hood switch. Install connector (1) to mate with hood switch (2).

1.7
Reposition cover over assembly and secure in place with plastic fastener previously removed in step 1.1.

2. Alarm Siren Installation

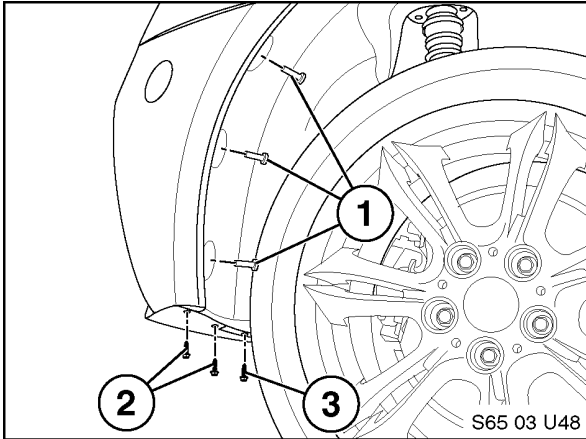

2.1
Remove the three plastic rivets (1) from RH rear wheel well as shown.

2.2
Remove the two hex head self tapping screws (2) and the one M5x12 hex head screw (3) from RH lower corner area of rear bumper as shown.

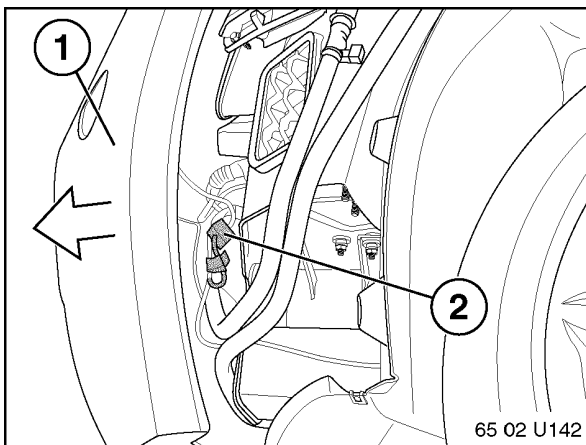

2.3
Slightly displace RH corner area of rear bumper (1) from RH wheel well area by about 10 inches (25.5 mm) to allow access to charcoal canister area (2) as shown.

2.4
Locate the 6-position siren connector (2). Remove securing tape allowing connector to be free.

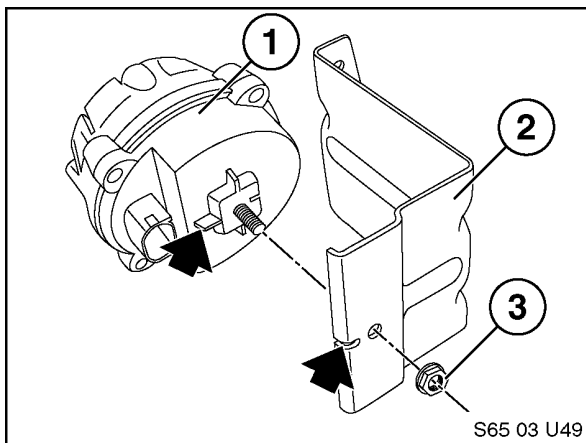

Note: Make sure notch on bracket aligns with ridge on siren (indicated by black arrows).

2.5
Position alarm siren (1) to mounting bracket (2) as shown.

2.6
Secure alarm siren (1) to bracket (2) using M6 nut with captive flat washer (3).

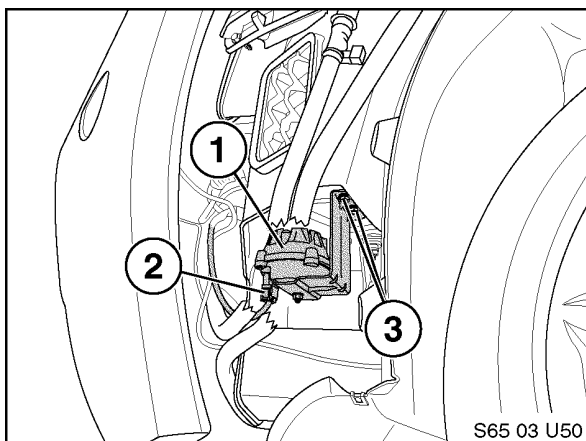

2.7
Connect 6-position alarm siren connector (2) to alarm siren (1).

2.8
Position alarm siren/bracket assembly so that pair of threaded studs (3) protrude through the pair of holes on bracket as shown.

2.9
Secure alarm siren/bracket assembly in place using pair of M6 nuts with captive flat washers.

2.10
Reassemble all previously displaced or removed items.

3. Coding of Alarm System

Important: Make sure CIP Version 7.0 or higher has been loaded in DISPlus/GT1 before proceeding.

3.1

Connect vehicle to DISPlus/GT1. Display DIS main page on DISPlus/GT1 screen. Press the "Coding/Program" field.

3.2

BMW Coding/programming menu page will appear. Press the "8 E65/E66/E85" field, then press right green arrow

3.3

CIP "Model series selection:" page will appear. Press the "E85" field.

3.4

CIP "Program SELECTION:" page will appear. Press the "Load SW" oval field on top of page.

3.5

Load software "Have control modules been replaced on this car? Note: for retrofits press No." page will appear. Press the "No" field.

Important: At this point, one of two scenarios will occur:

1. The program will look for appropriate operating levels of all control modules. If no anomalies are detected, the following page will appear:

- Load software "Select control module to be processed." After this page appears, proceed to step 3.6 and continue with instructions.

2. The program will look for appropriate operating levels of all control modules. If any anomalies are detected, the following page will appear:

- Load software "Status report". After this page appears, press the "Cancel Update" field on bottom right of page.

- The Load software "Select control module to be processed." page will now appear. After this page appears, proceed to step 3.6 and continue with instructions.

3.6

Once the Load software "Select control module to be processed." page appears, press the "Retrofits" field on bottom right of page.

3.7

Load software "Select retrofitting." page will appear. Press the "Retrofits" field on top right of page.

3. Coding of Alarm System

3.8

Load software "Add retrofits" page will appear. Press the "DWA" field.

3.9

Load software "Select subfunction for retrofitting or cancel with arrow in navigation column page will appear. Press the "Add" field.

3.10

Load software "Turn on ignition" page will appear. Turn on vehicle's ignition. Press the "Continue" field on bottom of page.

3.11

Load software "Is ignition on?" page will appear. Press the "Yes" field.

3.12

Load software "Final report" page will appear. If alarm coding was completely successful, green check marks will appear in operations field. If any problems were encountered, a red "X" will appear and list each fault.

3.13

Press the "Print" oval field on top of page to print out final report.

3.14

Press the "Finish" field on bottom left of page.

3.15

If there are all green check marks in Final report operations field, alarm coding has been successfully completed. No further action is necessary.

3.16

If there are any red "X" marks in Final report operations field, terminate from CIP. Start diagnosis program to clear fault memory. Re-enter CIP and retry coding of alarm system beginning at step 3.1.

3.17

If faults still persist, diagnose and correct faults. Clear fault memory and retry coding of alarm system beginning at step 3.1.