



BAVARIAN AUTOSPORT

# Cold Air Intake Kit Installation Instructions

**NOTE:** Filter cleaning and re-oiling: When cleaning your aFe filter, be sure to use only aFe's "Restore Kit" (aFe P/N: 90-50001 blue aerosol, or aFe P/N: 90-50501 blue squeeze bottle oil). Filter Replacement: P/N: 24-91007 (black w/blue media).

## 540i PART NUMBER:

97 thru 03 54-10471

### PROCEDURE:

1. Remove temperature sensor from stock air box (see Figure 1).
  
2. Remove two spring clips that connect the mass flow sensor to the stock air box (see Figure 2).
  
3. Remove bolt with 10mm socket or wrench and remove air box from engine (see Figure 3).
  
4. Assemble Venturi adapter to shield using five button head screws (see Figure 4).

Figure 1

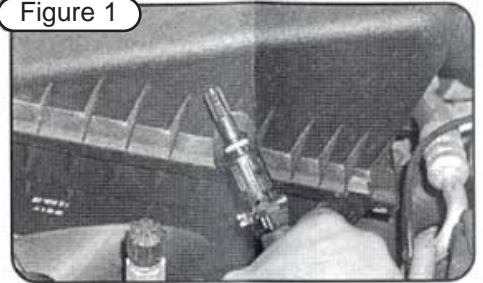

Figure 2

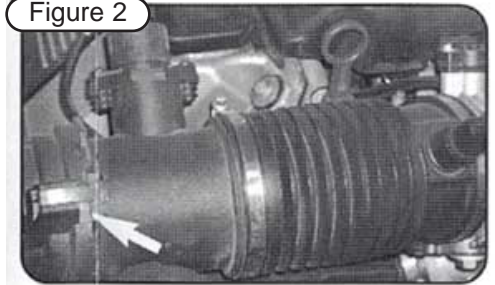

Figure 3

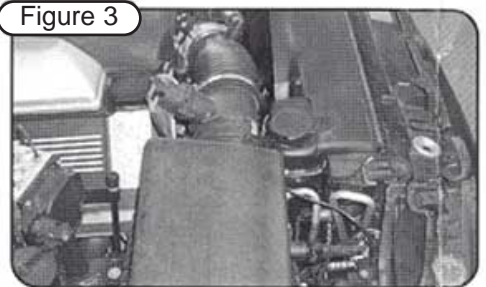
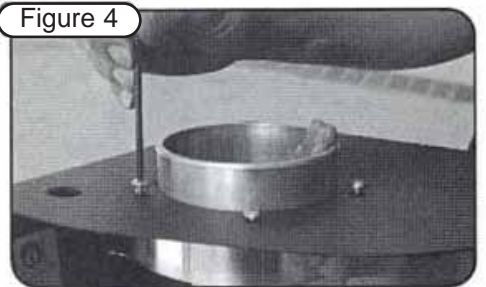

Figure 4



**BAVARIAN**  
autosport

275 Constitution Avenue, Portsmouth, NH 03801

• 603.427.2002

Call Toll Free: **1.800.535.2002**

• Fax 800.507.2002

• [www.BavAuto.com](http://www.BavAuto.com)

5. Insert rubber grommet (see Figure 5).

Figure 5

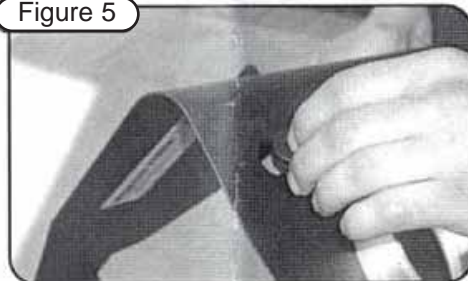

6. Slip on rubber adapter (do not tighten) (see Figure 6).

Figure 6

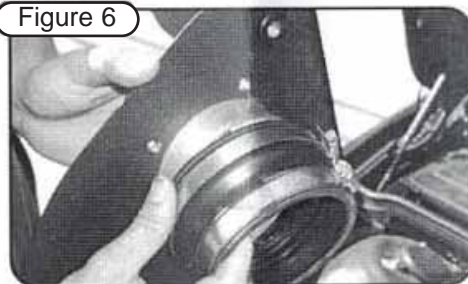

7. Install shield into vehicle (see Figure 7).

Figure 7

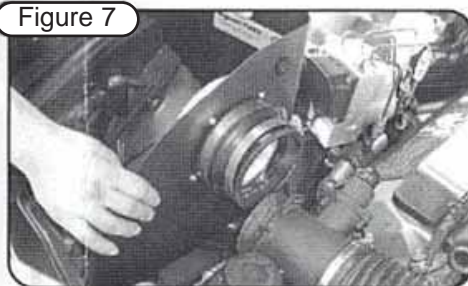

8. **A**, use provided 6mm screw, washer and lock washer (10mm); **B**, use factory nut (10mm); **C**, use factory screw (8mm) (see Figure 8).

Figure 8

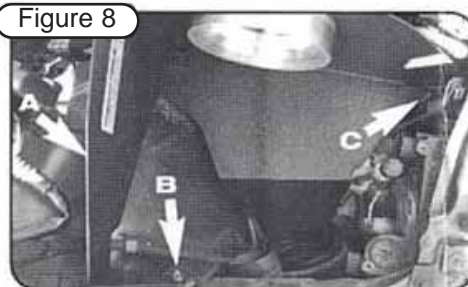

9. Tighten down two clamps that are used on the rubber adapter (see Figure 9).

Figure 9



10. Install temperature sensor (see Figure 10).

Figure 10

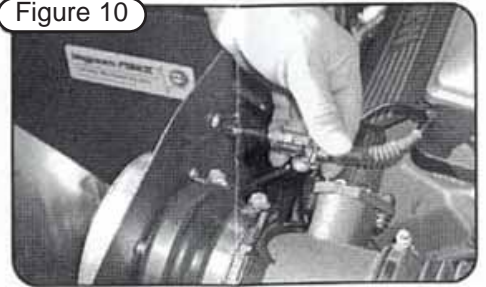

11. Install trim seal (see Figure 11).

Figure 11



12. Install filter (see Figure 12).

Figure 12

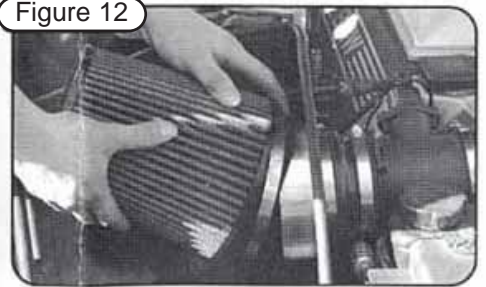

13. Make sure all hoses and clamps are tight and that all electrical components (if applicable) are secure. Check and retighten connections and filter after a few hours of operation (see Figure 13).

Figure 13

