



Installation Instructions

Page 1 of 10

January 2009

Audio, Alarm

Ver 4.0

Accessory
Development

These installation instructions supersede all previous versions.

SUBJECT

ALARM RETROFIT - P/N 65 73 0 427 835

MODEL

3 Series Convertible (E93): Select Vehicle Production 12/06 – 02/09*
3 Series Convertible M3 (E93): Select Vehicle Production 03/08 – 02/09*

* Vehicle must have optional alarm pre-wiring (SA 5GA).

SUGGESTED INSTALLATION TIME: 1.0 HOUR**

Suggested installation time includes re-coding of the vehicle only for this retrofit kit. This time is based on a vehicle that is at the current software level and does not require any updates. Before installing this Accessory into the vehicle, the vehicle should be checked for software updates. If updates are available the vehicle should be programmed prior to installing this accessory. **If vehicle is under warranty, the costs of programming prior to retrofit should use defect code 72 60 93 02 00.

Please refer to SI B09 05 01 for latest BMW approved Retrofit coding procedures.

Please refer to SI B01 09 06 – Defect Code for Programming Prior to Accessory Retrofit

Total installation time may vary depending on vehicle options and equipment.

Note: This retrofit kit does not include provisions for interior protection motion sensors. Additional parts, not included in the kit, are required if this optional feature is requested.

The instructions below are developed for BMW vehicles and are not to be compared to any other existing instructions for vehicles other than BMW. No methods other than those specified in this document are to be used for installation in BMW vehicles. Left and right are determined from the driver's seat.

Carefully read all instructions and supplements before proceeding with the installation. Reference should be made to TIS for instructions dealing with a stock part of the vehicle but not stated in detail in these instructions.

The instructions were complete and up to date at time of publication; however, changes to the vehicle or installation may have occurred. Please report any problems or changes noted with the installation to BMW via PuMA, along with VIN, date of manufacture and as much detail as possible.

★ ★ DO IT RIGHT THE FIRST TIME, ON TIME, EVERY TIME ★ ★

PARTS INFORMATION**Contents of Kit - P/N 65 73 0 427 835**

Description	Qty	BMW Part Number
Bracket for hood switch	1	61 31 6 932 791
Mounting plate	1	65 75 6 949 085
Bracket for siren/tilt sensor	1	65 75 6 949 084
Siren/Tilt sensor	1	65 75 9 142 445
Screw ST 4.8x13	1	07 11 9 901 202
Hood switch	1	61 31 9 119 052
M6 hex nut with captive washer	4	07 12 9 904 008
M6x18 screw with washer	2	07 11 9 904 093

ADDITIONAL PARTS FOR OPTIONAL INTERIOR PROTECTION

Description	Qty	BMW Part Number
DWA Alarm MDD Sensor	4	65 75 6 950 525
Fillister head self tapping screw	2	51 41 9 127 006
M6x12 socket head screw	2	07 11 9 919 913

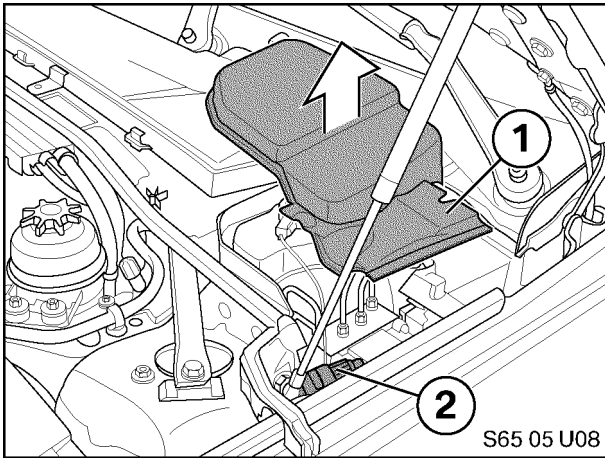
Hood Switch Installation (does not apply to M3)

1. Remove cover (1) by LH hood strut area.
2. Locate 3-position black hood switch connector and harness (2). Remove securing tape.

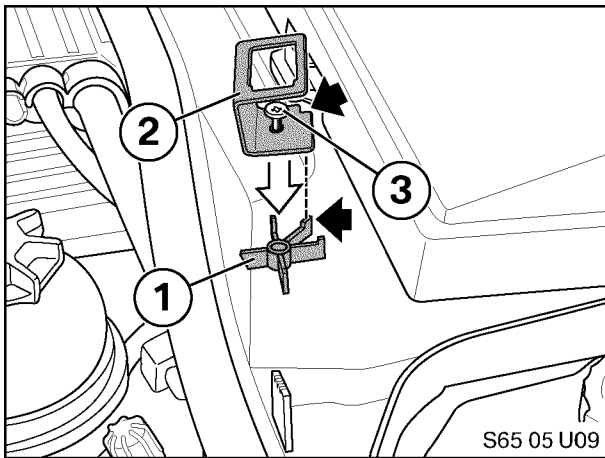

3. Position hood switch bracket (2) to mounting location (1) and secure in place with ST 4.8x 13 screw (3).

Note: Make sure “corner notch” on bracket faces reward and fits into base mounting tab as shown.

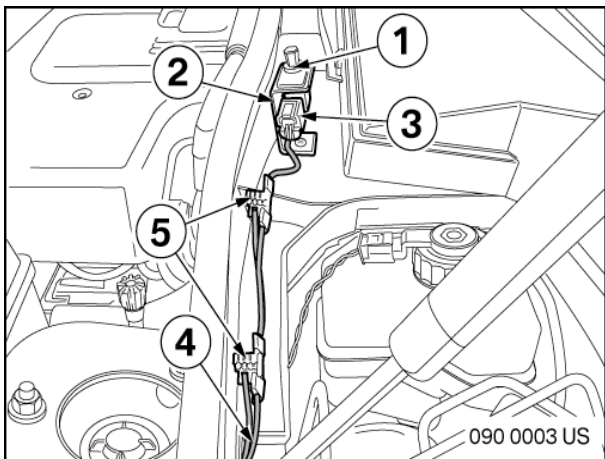

4. Insert hood switch (1) into hood switch bracket (2).
5. Connect hood switch connector (3) to hood switch (2).
6. Secure hood switch harness (4) by pushing cable clips (5) into mounting tabs.
7. Reinstall cover.

Alternate Power Siren/Tilt Sensor Installation

1. Remove LH rear wheel.
2. Remove LH rear wheel arch cover. See TIS 51 71 041

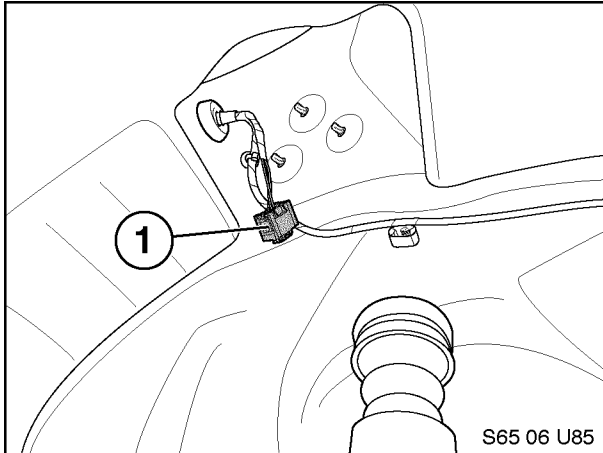

3. Locate 6-position black siren connector (1) in upper LH wheel arch area. Remove securing tape.

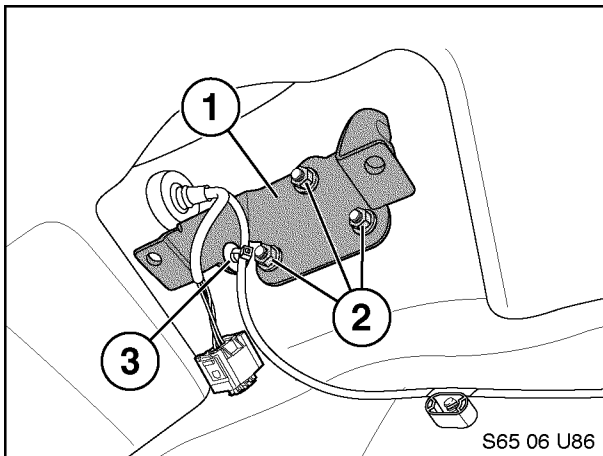

4. Install siren bracket (1) over threaded studs and secure in place with three M6 hex nuts (2).
5. Push harness retainer (3) into access hole on siren bracket to keep harness properly positioned.

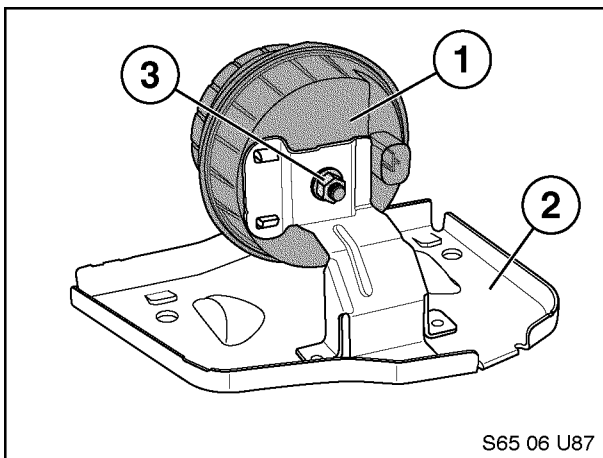

6. Position siren (2) to mounting plate (3) and secure in place with M6 hex nut (1).

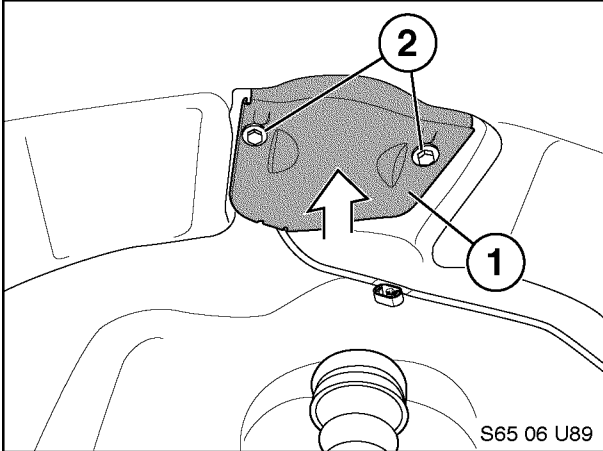
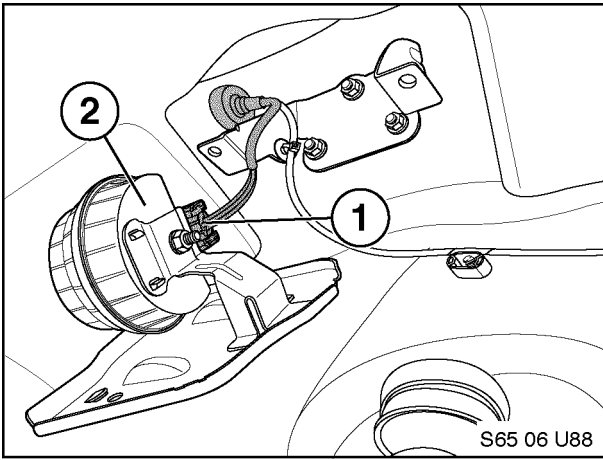

5

7. Connect 6-position black connector (1) to siren (2).

8. Use M6x18 hex screws (2) to secure mounting plate (1) to bracket as shown.

9. Reinstall LH rear wheel arch cover.

10. Reinstall LH wheel.

For vehicles without optional interior protection, skip to page 7 to continue with Retrofit Coding procedure.

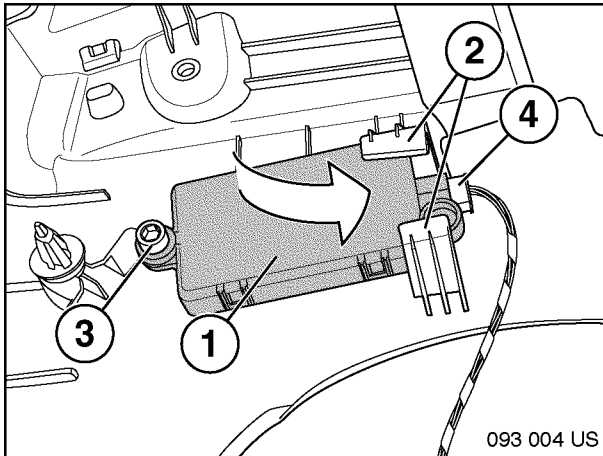
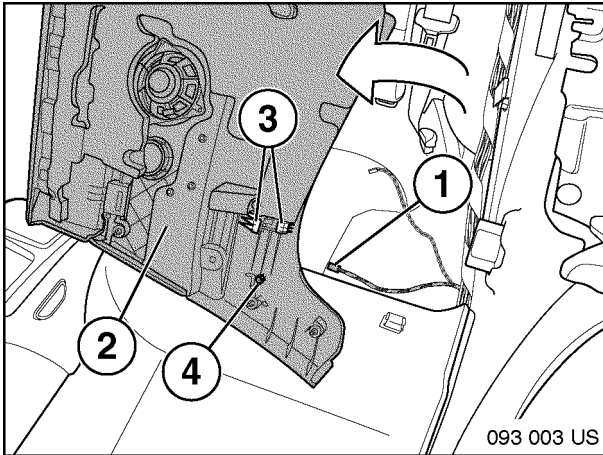
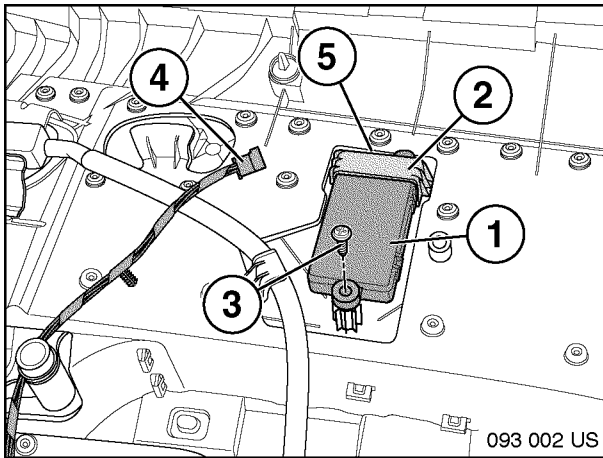
Interior Protection Installation-Optional

1. Remove front door panels. See TIS 51 41 000.
2. Install Interior protection sensor (1) behind molded bracket (2) of door panel and connect vehicle harness (4) to sensor (5). Secure sensor to door with self tapping screw (3).
3. Remove left and right rear side panels (2). See TIS 51 43 034.
4. Locate vehicle harness (1), molded bracket (3) and securing point (4).
5. Install interior protection sensor (1) behind molded bracket of vehicle panel (2) and secure using M6x12 screw (3).
6. Connect vehicle harness (4).

Installation Complete.

Continue with Retrofit Coding.

RETROFIT CODING

Note: Please refer to SI B09 05 01 for latest Progman retrofit procedure before starting vehicle coding.

Reconnect negative battery terminal.

Retrofit DWA (alarm system) using Progman V31.2.0 or later.

Follow approved Progman Retrofit procedures until Retrofit selection appears then:

Program session

Program selection: Retrofitting Alarm

- **Select** "Load SW"

Have control modules been replaced on this car?

- **Select** "No"

Screen will appear stating "Fitted control modules are being determined, followed by Select control module to be processed"

- **Select** "Retrofits"

Screen will appear stating "Selecting Retrofits"

- **Select** "Retrofits"

Screen will appear stating "Retrofits have been added"

- **Select** "DWA"

Screen will appear stating "Select sub function for retrofits or cancel with arrow in navigational column"

- **Select** "Added"

Screen will appear stating "Retrofitting Antitheft alarm system selected"

- **Select** "Continue"

Screen will appear stating "The voltage is being tested; vehicle context is being checked again" followed by "Measures plan is being determined"

Screen will appear stating "Selection of installed battery"

- **Select** "Continue"

Screen will appear stating "Is a 90 Ah AGM battery fitted?"

- **Select** "Yes"

Screen will appear stating "The voltage is being tested; vehicle context is being checked again" followed by "Measures plan is being determined"

Screen will appear stating "A measures plan has been created and accepted. It takes 2 minutes to execute this measures plan"

- **Select** "Start"

Screen will appear stating "The CKM values are being saved"; "The GM control module _____"; "The CKM values are being restored"

Screen will appear showing Measures Plan, DWA option code number K302 should be the last number listed in the vehicle order.

- Select "Print" if a printed copy of measures plan is desired.
- Select "Accept"

Final Report

- **Select** "Finish"
-

For vehicles without optional interior sensors:

- Follow above procedure again. This time selecting "Retrofits" and "interior sensor"

Screen will appear stating "Deactivate"

- **Select** "Deactivate" and continue with coding.
- Disconnect MOST connection when prompted and complete Progman session.
- **Select** "Finish"

Upon completion of anti-theft alarm system coding, allow vehicle to enter sleep mode and then conduct alarm system test to verify functionality of alarm system.

PERSONAL PROFILE SETTINGS

Personal Profile Settings allow the customer to modify select settings for the Alarm system.

For vehicles with optional Navigation (SA 609)

Settings can be selected via iDrive menu.

Please refer customer to Vehicle Owner's Manual "Personal Profiles" and "Alarm" sections for more information.

For vehicles without Navigation

The visual and audio confirmation settings can be modified via the Settings and Information on the Instrument Cluster using the left hand stalk.

All settings are set to active by default.

Please refer customer to Vehicle Owner's Manual "Alarm System" and "Settings and Information" sections for more information.

FUNCTIONAL TEST

Upon completion of retrofit coding, allow the vehicle to enter sleep mode. Verify that alarm system is working correctly by going through the following action and response steps in order listed to ensure alarm system is functioning properly.

Action	Response
<p>Lock vehicle and arm alarm system by pressing the round "Roundel" button on remote key.</p> <p>Vehicle is locked and alarm system armed but alarm status LED flashes rapidly for about 20 times, then flashes normally at 3 second intervals.</p>	<p>All doors,hood and trunk lock at same time. Alarm status LED on rearview mirror will begin flashing once every 3 seconds indicating properly functioning alarm system.</p> <p>This indicates a secure point (i.e. a door, the trunk or hood) is not secure. Locate and correct cause of secure point fault and retry locking vehicle and arming alarm system with remote key.</p> <p>Note: This rapid flashing LED will also be present if the retrofit coding was performed with older versions of Progman or coded incorrectly. Re-code DWA with latest version of Progman.</p>
<p>Check functionality of hood switch.</p> <p>Lock vehicle and arm alarm system with remote key.</p> <p>Push down on hood switch contact point.</p> <p>If alarm siren fails to sound, verify siren/tilt sensor is properly connected and repeat above procedure.</p>	<p>Open vehicle hood. Pull up on hood switch contact point to place hood switch in "test mode". This action simulates that hood is closed to alarm control module while vehicle hood is physically open.</p> <p>Verify that alarm status LED on rearview mirror is flashing normally at 3 second intervals after 15 seconds of rapidly flashing LED.</p> <p>This task should result in alarm siren sounding! Press "arrow" button on remote key to disarm alarm.</p>
<p>Check functionality of tilt sensor. Lock vehicle and arm alarm system by pressing the round "Roundel" button on remote key. Wait for alarm status LED to begin flashing once every 3 seconds.</p>	<p>Place a floor jack (with a protective pad to prevent contact with painted surface) on either side front or rear jacking point. Begin raising vehicle with floor jack. This action should result in alarm siren sounding! Press "arrow" button on remote key to disarm alarm.</p>
<p>If fault persists, check that retrofit coding was accepted, otherwise, a modified vehicle order may need to be installed.</p>	<p>Contact BMW Technical support via PuMA case stating problem. It may be necessary for a modified vehicle order file to be sent to you for loading into the vehicle's vehicle order to initiate proper function of alarm system.</p>

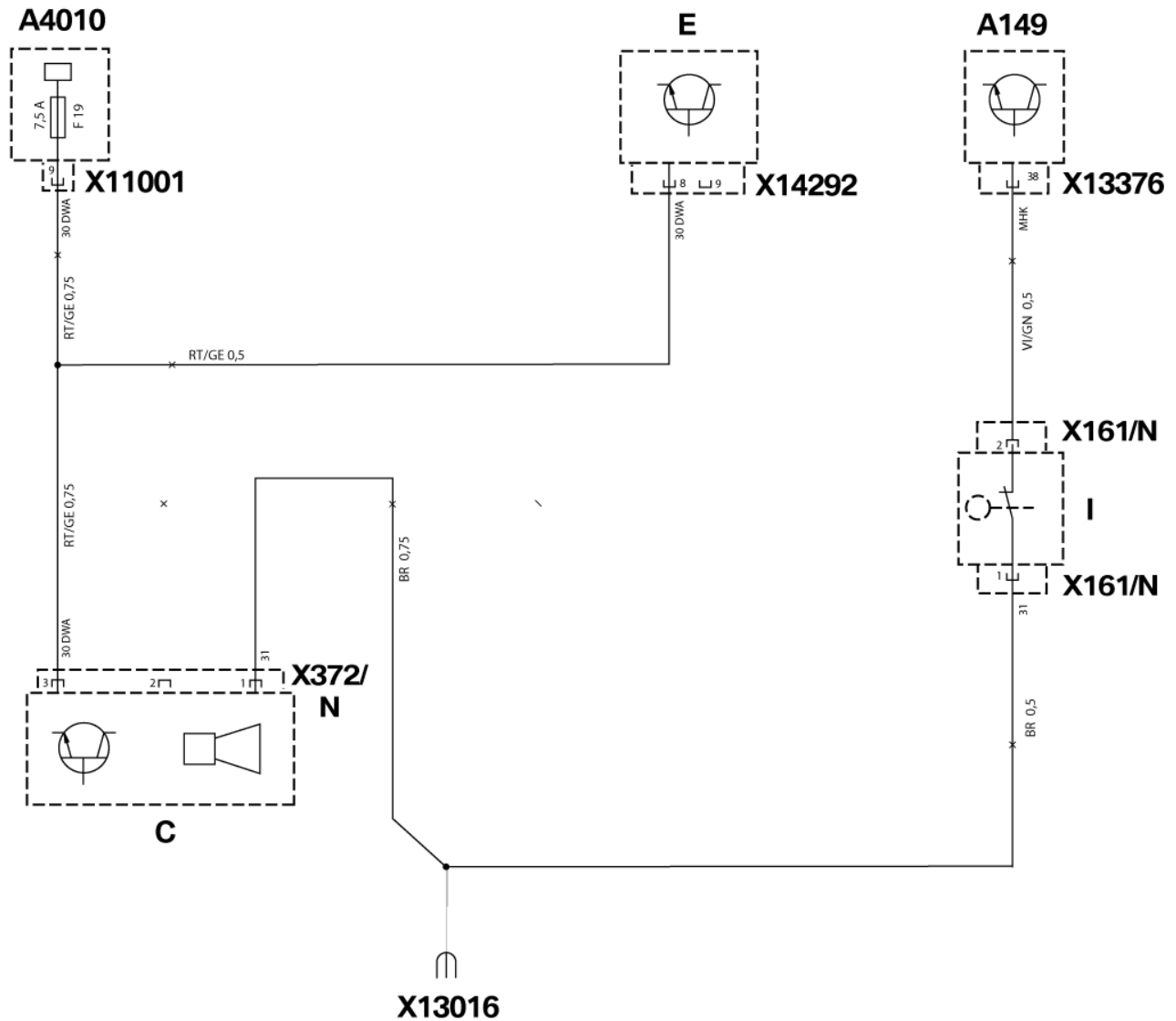
CIRCUIT DIAGRAM

090 0091 US

ALARM SYSTEM CIRCUIT DIAGRAM LEGEND

A149	CAS control module
A4010	Fuse holder
E	Interior mirror
C	Emergency-current siren
I	Hood switch
N	Black 3-pin
X161	3-pin black plug, to hood switch I
X372	3-pin plug, black to emergency-current siren C
X11001	15-pin black plug, to fuse holder A4010
X13016	Joint connector, terminal 31 tap
X13376	41-pin black plug, to CAS control module A149
X14292	10-pin black plug, to interior rear view mirror E

CABLE COLORS

BL	Blue
BR	Brown
GE	Yellow
GR	Grey
OR	Orange
RT	Red
SW	Black
VI	Violet
GN	Green