



Installation Instructions

Page 1 of 8

August 2006

Accessories, Alarm

Ver 2.0

Accessory
Development

These Installation Instructions supersede all previous versions.

SUBJECT

ALARM KIT WITH MDD - P/N 65 73 0 391 495

MODEL

3 Series Convertible (E46/C): Vehicle Production 3/04-On*

**Only with alarm pre-wiring which is standard for U.S. spec vehicles.*

SUGGESTED INSTALLATION TIME: 1.5 HOURS

Total installation time may vary depending on vehicle options and equipment.

The instructions below are developed for BMW vehicles and are not to be compared to any other existing instructions for vehicles other than BMW. No methods other than those specified in this document are to be used for installation in BMW vehicles. Left and right are determined from the driver's seat.

Carefully read all instructions and supplements before proceeding with the installation. Reference should be made to TIS for instructions dealing with a stock part of the vehicle but not stated in detail in these instructions.

The instructions were complete and up to date at time of publication; however, changes to the vehicle or installation may have occurred. Please report any problems or changes noted with the installation to BMW Technical Hotline, along with VIN, date of manufacture and as much detail as possible.

★ ★ DO IT RIGHT THE FIRST TIME, ON TIME, EVERY TIME ★ ★

PARTS INFORMATION**Contents of Kit - P/N 65 73 0 391 495**

Description	Qty	BMW Part Number
Tilt Sensor	1	65 75 6 923 215
M6x10mm Hex Bolt w/Flat Washer	2	07 11 9 915 041
Motion Sensor Front	1	65 75 6 974 632
Motion Sensor Rear	1	65 75 6 974 633
Plastic Nut	1	16 13 1 175 747
Siren (USA)	1	65 75 8 383 153
M6 Hex Nut w/Captive Flat Washer	1	11 61 1 708 413
Siren Bracket	1	65 75 8 377 290
M6x16mm Hex Bolt w/Flat Washer	1	07 11 9 915 039
M6 Prestal-Cage Clip	1	32 41 1 095 443
Adapter Cable	1	61 12 6 944 874
Template	1	01 29 0 026 907

ADDITIONAL REQUIRED PARTS

Description	BMW Part Number
Rear Motion Sensor Housing-Black*	51 16 7 024 827
Rear Motion Sensor Housing-Gray*	51 16 7 024 828
Rear Motion Sensor-Housing-Beige*	51 16 7 024 829

**Part in desired trim color must be ordered in addition to this alarm kit*

Procedure

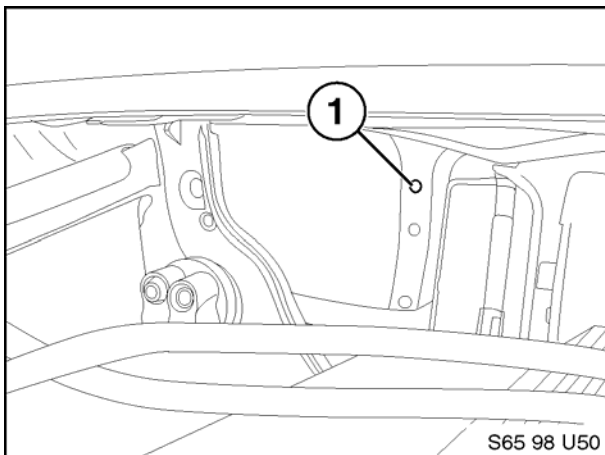
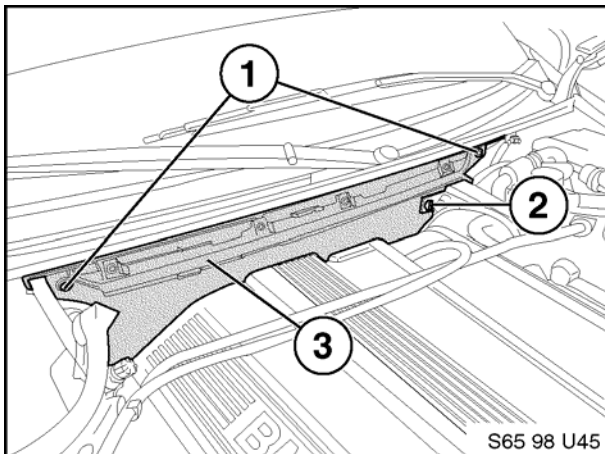
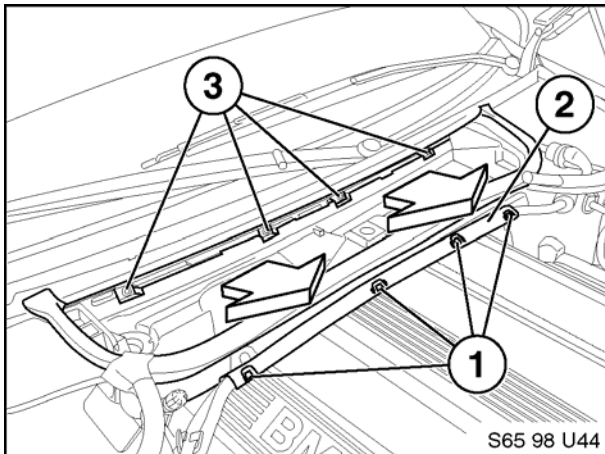
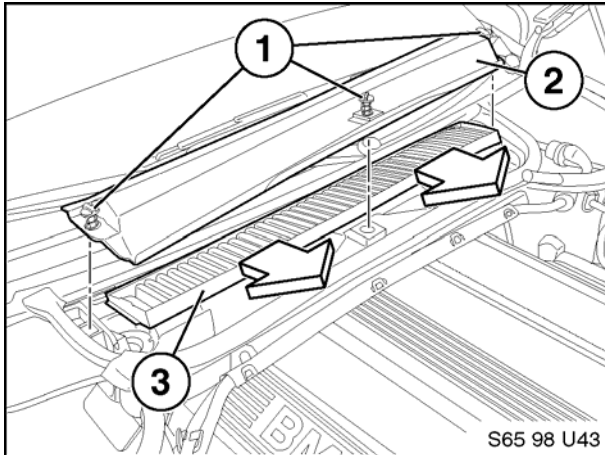

3

Alarm Siren

1. Disconnect battery negative terminal.
2. Release (1/4 turn) the three spring loaded fasteners (1) on grill cover (2).
3. Remove air collector (3).
4. Carefully pry up on the four upper retainers (1) and remove cable channel cover (2) from cable channel.
5. Remove wire harness from cable channel.
6. Loosen the four 30 Torx[®] head captive bolts (3) and remove forward cowl panel.
7. Loosen the two 30 Torx[®] head captive bolts (1) on rearward cowl panel (3).
8. Release (1/4 turn) plastic retainer (2) and remove from rearward cowl panel.
9. Look into RH (passenger side) of firewall area (1) to determine mounting fastener requirements. If M6 threaded insert or M6 cage clip is already in place, proceed to step 11. If a square hole is in this location, proceed to step 10.

4

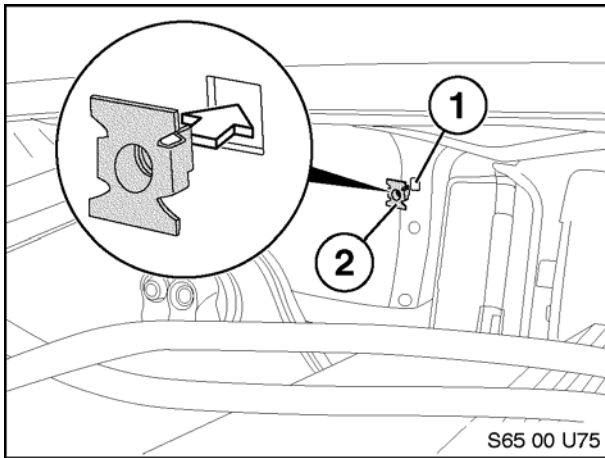

10. Insert cage clip nut (2) into square hole (1). Press firmly on cage clip until it is fully flush with mounting surface.

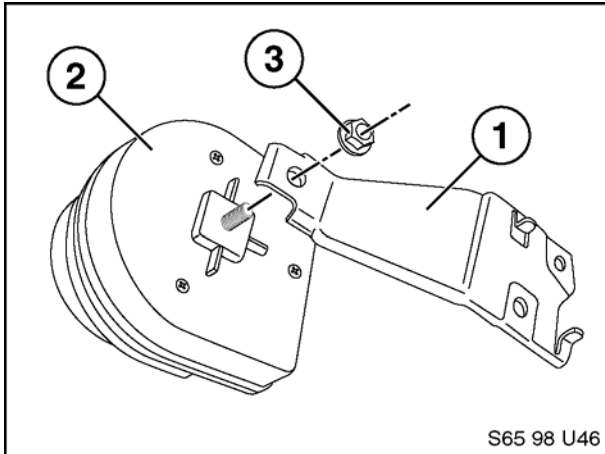

11. Assemble alarm siren (2) to mounting bracket (1) using M6 nut with captive flat washer (3).

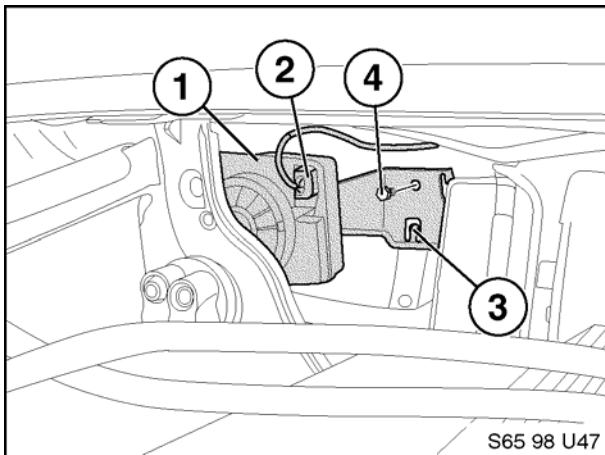

12. Locate (found taped to adjacent wire harness in RH cowl area) 4-position alarm siren connector (2) and connect to alarm siren (1).
13. Position alarm siren/mounting bracket assembly into mounting position utilizing the positioning tab (3). Secure alarm siren assembly in place with M6x16mm hex head bolt with captive flat washer (4).
14. Reassemble all displaced or previously removed items.

Tilt (Inclination) Sensor

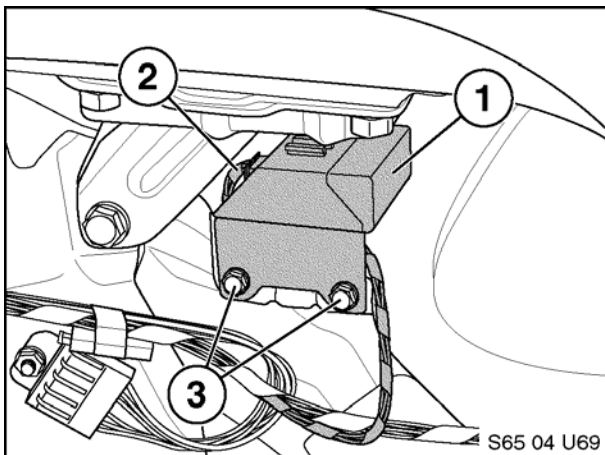

1. Partially remove RH rear trunk panel enough to gain access where the pair of 6mm tapped holes are located for mounting of alarm inclination sensor.
2. Position inclination sensor/bracket assembly (1) over the pair of M6 tapped holes and secure in place with pair of M6x10 hex head bolts (3).
3. Locate and connect 6-position connector (2) to inclination sensor (1).
4. Reassemble all displaced or previously removed items.

Alarm Interior Protection

Note: Before proceeding make sure hands are clean to prevent soiling of interior parts.

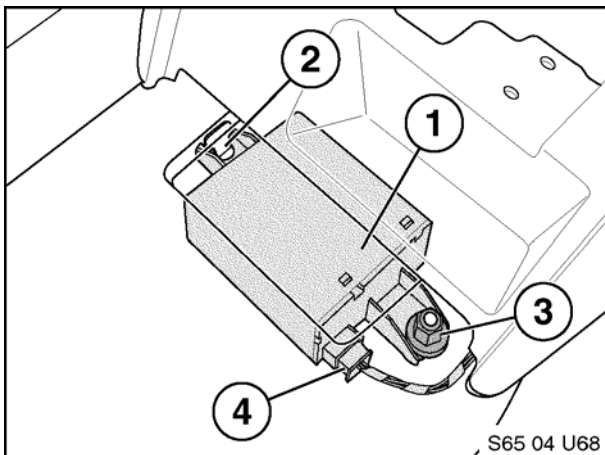
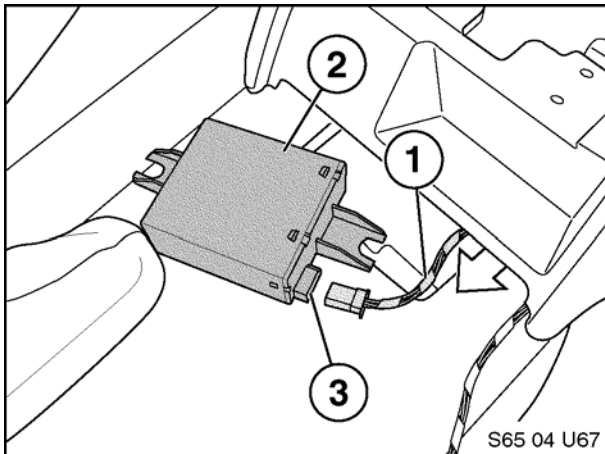
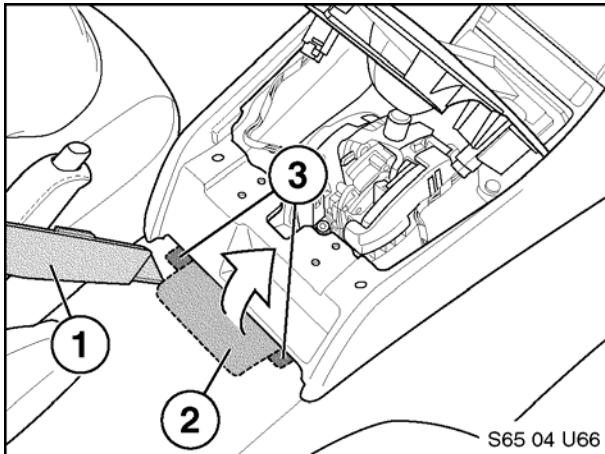
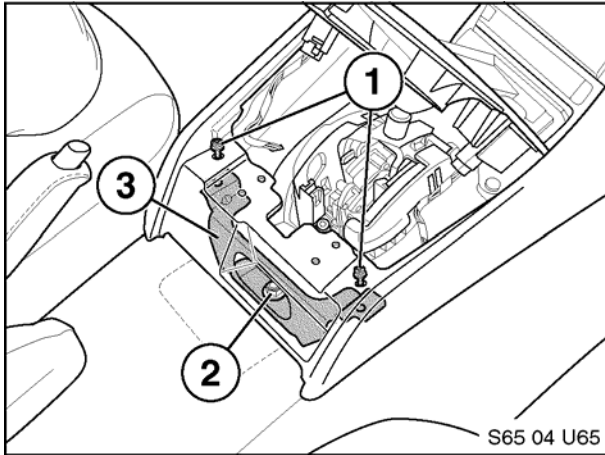

1. Remove storage tray from vehicle. See TIS No. 51 16 100.
2. Remove self-tapping screws (1) and nut (2) to allow removal of holder (3).
3. Use a utility knife (1) (**being cautious not to damage wiring harness of airbag control unit**) to remove partially scored 4" x 2-5/16" (10cm x 6 cm) carpet patch area (2).
4. Use a utility knife (1) to remove a 3/4" (2cm) square patch of carpet (3) on each side of the removed carpet patch (2) as shown to expose the LH mounting guide and the RH threaded stud.
5. Locate the 4-position black connector (1) found under forward center console near gearshift.
6. Connect 4-position black connector (1) to front motion sensor (3) as shown.
7. Position front motion sensor (1) so that LH mounting tabs are installed around the mounting guide (2) while the RH mounting tabs are positioned over the threaded stud (3) and secure in position with plastic nut as shown.

Note: LH mounting tabs on front motion sensor may need to be widened from 6mm to 10mm apart to accommodate fitment into mounting guide (2).

Note: Connector (4) must face RH (passenger) side.

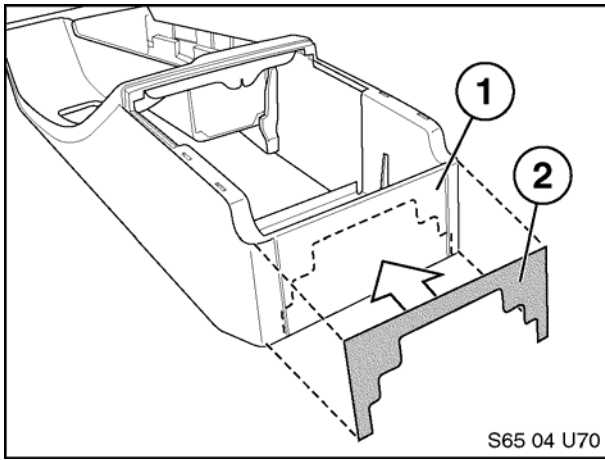

- 6
8. Carefully cut out template provided with kit.
9. Place template on center console back and mark outline of template shown.
10. Cut out indicated area (2) using a Dremel® or equivalent rotary tool with a high-speed cutter bit.

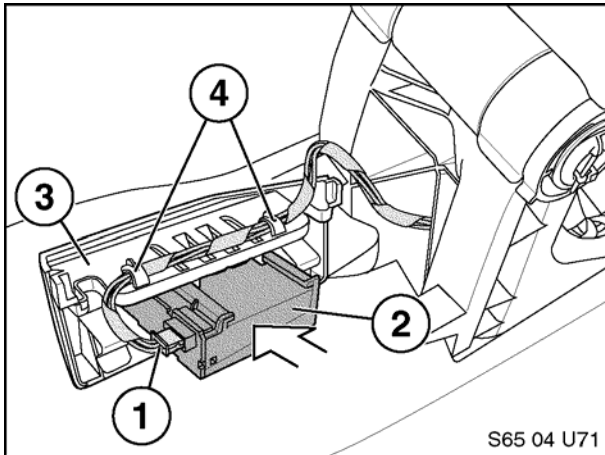

For Vehicles without Bluetooth® Antenna

1. Position (do not fully set into mounted position) rear motion sensor (2) into rear motion sensor housing (3) as shown.
2. Locate the 4-position black connector found under opening in carpet in rear area of center console.
3. Connect 4-position black connector (1) to rear motion sensor (2) as shown.
4. Fully set rear motion sensor into position by pushing sensor (2) into housing (3) until sensor locks into position.
5. Route remaining length of rear motion sensor connector cable through housing mounting clips (4).
6. Proceed to step 7.

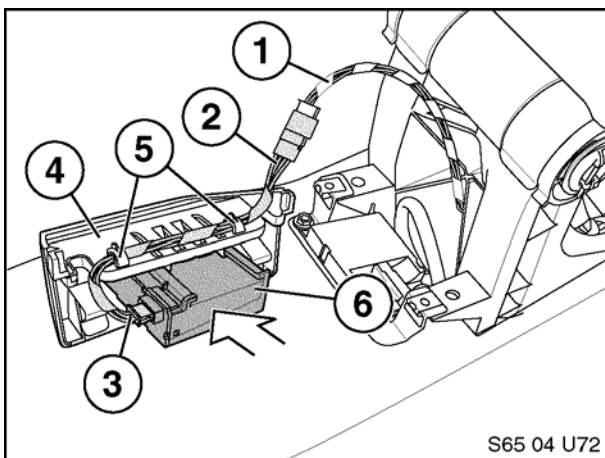

For Vehicles with Bluetooth Antenna

1. Position (do not fully set into mounted position) rear motion sensor (6) into rear motion sensor housing (4) as shown.
2. Locate the 4-position black connector cable (1) found under opening in carpet in rear area of center console.
3. Connect 4-position black connector cable (1) to adapter cable receptacle connector end (2).
4. Connect adapter cable plug connector end (3) to rear motion sensor (6) as shown.
5. Fully set rear motion sensor into position by pushing sensor (6) until sensor locks into position.
6. Route remaining length of adapter cable through housing mounting clips (5).

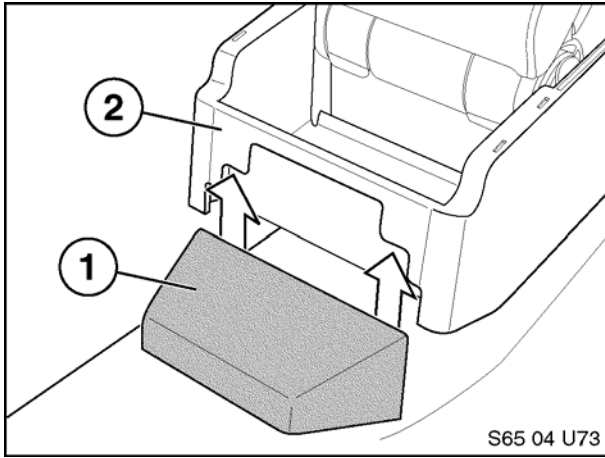

7

7. Position rear motion sensor housing (1) onto center console (2) as shown. Make sure clips on each side of housing attach to console ensuring a flush fit.

8. Reassemble all displaced or previously removed items.
9. Reconnect battery negative terminal. After completion of above installation, the retrofit anti-theft alarm system (DWA) must be coded to the vehicle using DISPlus or GT1.

Installation Complete

Continue with Retrofit Coding.

RETROFIT CODING**CENTRAL CODING KEY (ZCS) PROCEDURE**

When all of the above work has been completed, the retrofit anti-theft alarm system needs to be coded by using a DISPlus or GT-1. Coding is possible with Version C13.0 or later software.

Note: Failure to perform the Central Coding Key (ZCS) coding procedure will render anti-theft alarm system inoperative.

- Reconnect battery negative terminal.
- Connect vehicle to DISPlus or GT-1.
- Turn ignition key of vehicle to position 2.
- Select “CODING/PROGRAM” selection on the right side of the DIS Tester screen.
- Select “3 ZCS/FA CODING” followed by the RH green arrow.
- The following informational screen will appear “Coding by means of Central Coding Key (ZCS)/Vehicle Order (VO) Version Cxx.0”.
- Select the RH green arrow.
- The following informational screen will appear “IMPORTANT: With coding by means of the ZCS/VO, the changes made using the CAR/KEY MEMORY program can be overwritten. These are to be reset as required.
- Select the RH green arrow.
- Select “7 E46 Series” followed by the RH green arrow.
- Select “2 Retrofit” followed by the RH green arrow.
- The following informational screen will appear “Important! After successful completion of retrofitting the control unit must additionally be added in the diagnosis under “Service functions, body, electronic immobilizer, Enter retrofit.” Select the RH green arrow.
- Select “2 Anti-theft alarm system” followed by the RH green arrow.
- The following informational screen will appear “Retrofit anti-theft alarm system. Refer to installation instructions from the installation set!” Select the RH green arrow
- The “GM V” screen will appear. Select “2 without steady signal” followed by the RH green arrow.
- The “Activation/Deactivation of DWA via:” screen will appear. Select “1 Remote control or door lock” followed by the RH green arrow.
- The following informational screen will appear “The anti-theft alarm is coded with emergency power siren and interior protection.” Select the RH green arrow.
- The following informational screen will appear “GM V is recoded and the vehicle order in KOMBI automatically changed. Select the RH green arrow.
- The following screen will appear “GM V Start automatic coding? Select “Yes”
- The following informational screen will appear “Vehicle order saved for printout Coding completed! Turn ignition off. Wait for 10 seconds. Turn ignition on again and carry out functional check.
- The following informational screen will appear “GM V Vehicle order has been changed! New central label required! Vehicle order: Model series: E46 Type Des. Code: Time criterion: Paint code: Upholstery code: Assbly. No.: Select down green arrow. The vehicle SA code order will appear.
- Select down green arrow again to show the remaining vehicle SA code order. Code 302 should appear at the end of the vehicle code order. Select down green arrow.
- Turn ignition key off for 10 seconds, then turn ignition key to position 2.
- Turn ignition key off and remove key from ignition.
- Close all doors.

Upon completion of anti-theft system retrofit coding conduct functional test of alarm system.